

REDUKCJA GWINTOWANA nakrętna Z16

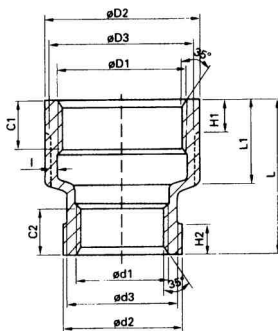

gwint wykonany wg normy:
DIN

materiał: AISI 304, AISI 316

Rozmiar	D1	D2	D3	C1	H1	d1	d2	d3	C2	H2	L1	L	I
cal	cal	mm	mm	mm	mm	cal	mm	mm	mm	mm	mm	mm	mm
1/4"x1/8"	1/4"	20,0	18,0	6,2	6,0	1/8"	16,0	14,0	11,0	6,0	16,0	28,5	3,0
3/8"x1/8"	3/8"	25,5	23,0	9,4	7,0	1/8"	16,0	14,0	12,0	6,0	23,0	41,0	3,0
3/8"x1/4"	3/8"	25,5	23,0	9,7	7,0	1/4"	20,0	18,0	13,0	6,0	23,0	41,0	3,0
1/2"x1/8"	1/2"	30,0	28,0	10,0	8,0	1/8"	16,0	14,0	9,0	7,0	24,0	45,0	2,5
1/2"x1/4"	1/2"	30,0	28,0	10,0	8,0	1/4"	20,0	18,0	15,0	6,0	24,0	45,0	2,5
1/2"x3/8"	1/2"	30,0	28,0	10,0	8,0	3/8"	25,5	23,0	10,0	7,0	24,0	45,0	2,5
3/4"x1/8"	3/4"	36,0	33,0	10,0	9,0	1/8"	16,0	14,0	13,0	7,0	22,0	45,0	3,0
3/4"x1/4"	3/4"	36,0	33,0	10,0	9,0	1/4"	20,0	18,0	11,0	7,0	25,0	45,0	3,0
3/4"x3/8"	3/4"	36,0	33,0	10,0	9,0	3/8"	25,5	23,0	15,0	7,0	25,0	45,0	3,0
3/4"x1/2"	3/4"	36,0	33,0	10,0	9,0	1/2"	30,0	28,0	15,0	8,0	25,0	45,0	3,0
1"x1/8"	1"	45,0	42,0	14,0	9,0	1/8"	16,0	14,0	12,0	7,0	26,0	50,0	3,0
1"x1/4"	1"	45,0	42,0	14,0	11,0	1/4"	20,0	18,0	13,0	7,0	28,0	50,0	3,0
1"x3/8"	1"	45,0	42,0	14,0	11,0	3/8"	25,5	23,0	14,0	7,0	28,0	50,0	3,0
1"x1/2"	1"	45,0	42,0	14,0	11,0	1/2"	30,0	28,0	17,0	8,0	28,0	50,0	3,0
1"x3/4"	1"	45,0	42,0	14,0	11,0	3/4"	36,0	33,0	15,0	11,0	28,0	50,0	3,0
1 1/4"x1/4"	1 1/4"	53,0	50,0	18,0	11,0	1/4"	20,0	18,0	15,0	6,0	29,0	50,0	3,5
1 1/4"x3/8"	1 1/4"	53,0	50,0	18,0	11,0	3/8"	25,5	23,0	12,0	8,0	29,0	50,0	3,5
1 1/4"x1/2"	1 1/4"	53,0	50,0	18,0	11,0	1/2"	30,0	28,0	13,0	10,0	29,0	50,0	3,5
1 1/4"x3/4"	1 1/4"	53,0	50,0	18,0	12,0	3/4"	36,0	33,0	13,0	10,0	29,0	50,0	3,5
1 1/4"x1"	1 1/4"	53,0	50,0	18,0	12,0	1"	45,0	41,0	18,0	11,0	29,0	50,0	3,5
1 1/2"x1/4"	1 1/2"	60,0	56,5	18,0	12,0	1/4"	20,0	18,0	18,0	6,0	31,0	57,0	3,5
1 1/2"x3/8"	1 1/2"	60,0	56,5	18,0	12,0	3/8"	25,5	23,0	18,0	8,0	31,0	57,0	3,5
1 1/2"x1/2"	1 1/2"	60,0	56,5	18,0	12,0	1/2"	30,0	28,0	17,0	9,0	31,0	57,0	3,5
1 1/2"x3/4"	1 1/2"	60,0	56,5	18,0	12,0	3/4"	36,0	33,0	19,0	10,0	31,0	57,0	3,5
1 1/2"x1"	1 1/2"	60,0	56,5	18,0	12,0	1"	45,0	41,0	17,0	11,0	31,0	57,0	3,5
1 1/2"x1 1/4"	1 1/2"	60,0	56,5	18,0	12,0	1 1/4"	53,0	50,0	20,0	12,0	31,0	57,0	3,5
2"x1/4"	2"	74,0	70,0	18,0	13,0	1/4"	20,0	18,0	16,0	5,0	38,0	67,0	4,0
2"x3/8"	2"	74,0	70,0	18,0	13,0	3/8"	25,5	23,0	13,0	8,0	38,0	67,0	4,0
2"x1/2"	2"	74,0	70,0	18,0	13,0	1/2"	30,0	28,0	15,0	9,0	38,0	67,0	4,0
2"x3/4"	2"	74,0	70,0	18,0	13,0	3/4"	36,0	33,0	15,0	10,0	38,0	67,0	4,0
2"x1"	2"	74,0	70,0	18,0	13,0	1"	45,0	41,0	17,0	11,0	38,0	67,0	4,0
2"x1 1/4"	2"	74,0	70,0	18,0	13,0	1 1/4"	53,0	50,0	18,0	12,0	38,0	67,0	4,0
2"x1 1/2"	2"	74,0	70,0	18,0	13,0	1 1/2"	60,0	56,5	20,0	12,0	38,0	67,0	4,0
2 1/2"x3/4"	2 1/2"	90,0	86,0	23,0	14,0	3/4"	36,0	33,0	19,0	9,0	43,0	76,0	6,5
2 1/2"x1"	2 1/2"	90,0	86,0	23,0	14,0	1"	45,0	41,0	19,0	11,0	43,0	76,0	6,5
2 1/2"x1 1/4"	2 1/2"	90,0	86,0	23,0	14,0	1 1/4"	53,0	50,0	22,0	12,0	43,0	76,0	6,5
2 1/2"x1 1/2"	2 1/2"	90,0	86,0	23,0	14,0	1 1/2"	60,0	56,5	23,0	12,0	43,0	76,0	6,5
2 1/2"x2"	2 1/2"	90,0	86,0	23,0	14,0	2"	74,0	70,0	22,0	14,0	43,0	76,0	6,5
3"x1/2"	3"												
3"x3/4"	3"	109,0	104,0	24,0	15,0	3/4"	36,0	33,0	14,0	10,0	49,0	85,0	6,5
3"x1"	3"	109,0	104,0	24,0	15,0	1"	45,0	41,0	16,0	11,0	49,0	84,0	6,5
3"x1 1/4"	3"	109,0	104,0	24,0	15,0	1 1/4"	53,0	50,0	19,0	12,0	49,0	84,0	6,5
3"x1 1/2"	3"	109,0	104,0	24,0	15,0	1 1/2"	60,0	56,5	20,0	13,0	49,0	85,0	6,5
3"x2"	3"	109,0	104,0	24,0	15,0	2"	74,0	70,0	20,0	13,0	43,0	79,0	6,5
3"x2 1/2"	3"	109,0	104,0	24,0	15,0	2 1/2"	90,0	86,0	26,0	14,0	49,0	83,0	6,5
4"x1"	4"	138,0	132,0	25,0	16,0	1"	45,0	41,0	24,0	11,0	55,0	97,0	6,5
4"x1 1/4"	4"	138,0	132,0	25,0	16,0	1 1/4"	53,0	50,0	22,0	12,0	53,0	95,0	6,5
4"x1 1/2"	4"	138,0	132,0	25,0	16,0	1 1/2"	60,0	56,5	24,0	13,0	53,0	95,0	6,5
4"x2"	4"	138,0	132,0	25,0	16,0	2"	74,0	70,0	24,0	14,0	53,0	97,0	6,5
4"x2 1/2"	4"	138,0	132,0	25,0	16,0	2 1/2"	90,0	86,0	29,0	15,0	53,0	96,0	6,5
4"x3"	4"	138,0	132,0	25,0	16,0	3"	109,0	104,0	25,0	16,0	55,0	98,0	6,5